

4.7 Executive offices

An office of this kind may be the workplace of a manager or the office of a self-employed person. It consists of a working area and conference area, each area with specific lighting requirements.

In contrast to the purely functional lighting in the other office spaces, atmosphere and prestigious effect are also important aspects in this case.

As rooms of this kind are used for a variety of activities, it is advisable to develop a design concept that allows the switching and dimming of different groups of luminaires to meet changing requirements.

Recessed downlights arranged in a rectangle around the perimeter of the room provide ambient lighting. A task light is installed on the desk.

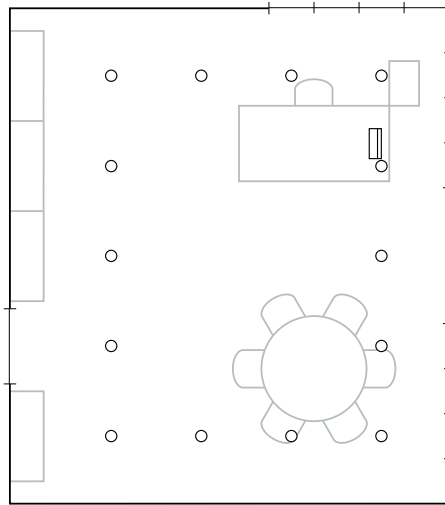

Task light for compact fluorescent lamps.

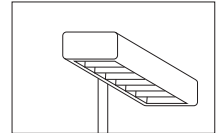

Recessed downlight for general service lamps.

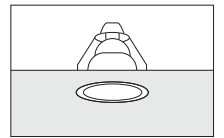

Washlights on the end walls provide the general lighting in the room. The desk receives direct light from two directional spotlights. A group of four downlights accentuate the conference table.

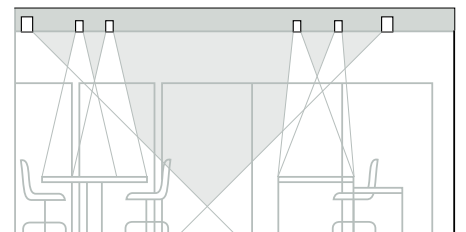
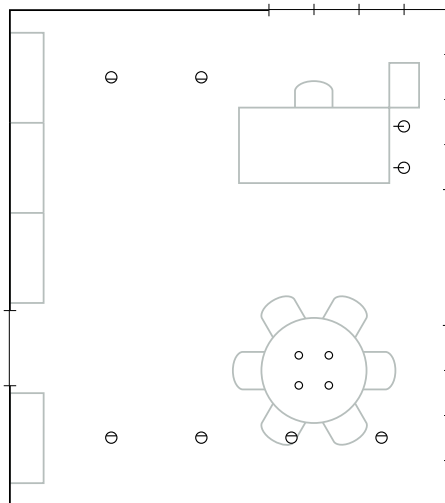

Recessed downlight for low-voltage halogen lamps.

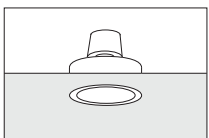

Recessed directional spotlight for halogen reflector lamps.

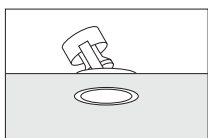

Recessed wallwasher for general service lamps.

